

CQH/CQV SERIES CONNECTOR



The CQH and CQV Series are designed for high-purity use and feature all plastic construction. Molded, virgin materials and lubricant-free design enable use in the most demanding applications. Broad chemical compatibility and cleanroom manufacturing make them ideal for use in critical wet processes.

FEATURES

- 100% metal free
- High flow valve design
- Disconnect under pressure
- Polypropylene and PVDF

BENEFITS

- No risk of metal contaminants or corrosion
- High flow in a compact package
- Speeds servicing and reduces risk of injury
- Broad chemical compatibility

Specifications ● ● ●

CQH PRESSURE:

0 - 80 psig (0 - 5.5 bar)

CQH TEMPERATURE:

32°F to 225°F (0°C to 107°C)

CQH MATERIALS:

Main components: Natural, virgin polypropylene
Valve o-rings: FKM (black)
External insert o-ring: Simriz® FFKM perfluoro black)
Valve (wetted) and thumb latch spring: PEEK®
Flare nuts: PVDF
Lubricants: None used

CQV PRESSURE: 0 - 80 psig (0 - 5.5 bar)

CQV TEMPERATURE:

0°F to 225°F (-18°C to 107°C)

CQV MATERIALS:

Main components: Natural, virgin PVDF
Valve o-rings: Chemraz FFKM perfluoro (white)
External insert o-ring: Chemraz FFKM perfluoro (white)
Valve (wetted) and thumb latch spring: PEEK
Flare nuts: PVDF
Lubricants: None used

SPILLAGE/AIR INCLUSION:

~1.5 cc (ml)/disconnect (reconnect)

TUBING SIZES:

1/4" to 1/2" flare; 3/8" to 3/4" NPT

NOTE: CQH & CQV are also available with optional PPS springs and Chemraz FFKM or EPDM seals.

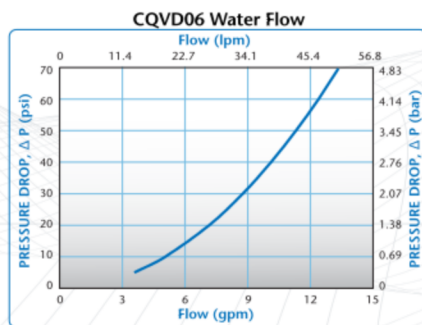
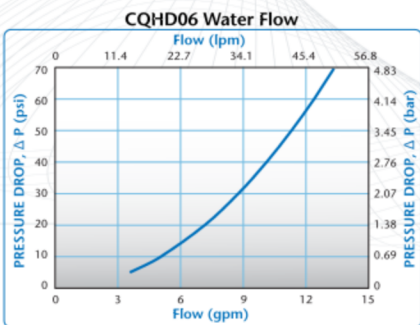
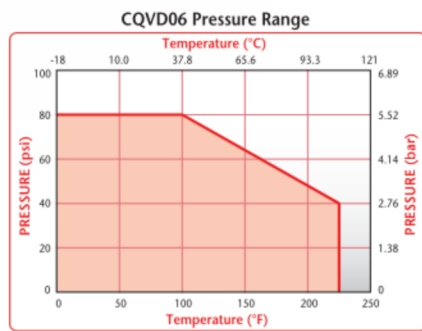
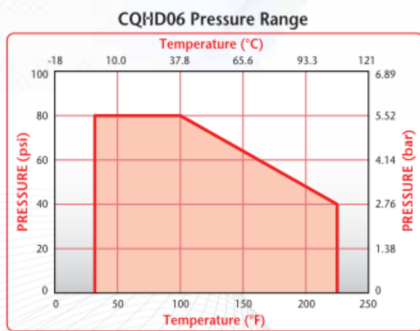

These graphs are intended to give you a general idea of the performance capabilities of each product line. The shaded area of each graph represents the operating range of the product family, i.e., upper and lower values are shown. Therefore, depending on the exact coupling configurations selected, you can reasonably expect values to fall within the shaded area.

See page 141 for ChemQuik Dual Containment Nut options.

CQH/CQV SERIES CONNECTOR DIMENSIONS

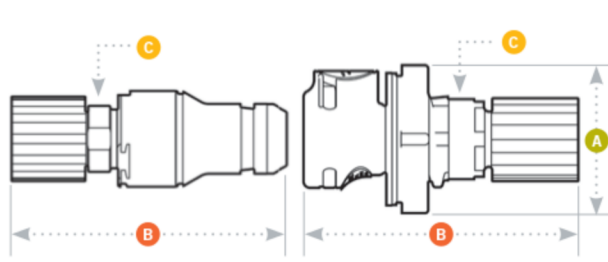

- A** = Height/Diameter
- B** = Total Length (including valve)
- C** = Hex Size on Main Component

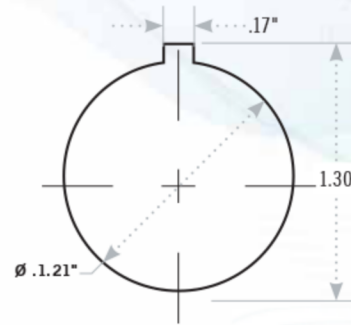

Gasket Thickness: .06"
 Mounting Hole: 1.21" diameter
 Coupling Spacing: 1.92" minimum
 Panel Thickness: .25"

	PANEL OPENING	PANEL THICKNESS MAX.-MIN.
COUPLING BODIES	see drawing	.25 - .03

CQH Coupling Bodies • POLYPROPYLENE

TERMINATION	TUBING/THREAD SIZE	TERMINATION TYPE	SHUTOFF	A	B	C
IN-LINE	1/4" OD	Flare compression	CQHD06100104	1.44	3.32	
	3/8" OD	Flare compression	CQHD06100106	1.44	3.38	
	1/2" OD	Flare compression	CQHD06100108	1.44	3.38	
	3/8" Taper	Male NPT	CQHD06100206	1.44	2.73	1.00
PANEL MOUNT	1/4" OD	Flare compression	CQHD06110104	1.82	3.32	
	3/8" OD	Flare compression	CQHD06110106	1.82	3.38	
	1/2" OD	Flare compression	CQHD06110108	1.82	3.37	
	3/8" Taper	Male NPT	CQHD06110206	1.82	2.73	1.00

CQH Coupling Inserts • POLYPROPYLENE

TERMINATION	TUBING/THREAD SIZE	TERMINATION TYPE	SHUTOFF	A	B	C
IN-LINE	1/4" OD	Flare compression	CQHD06200104	1.00	2.49	
	3/8" OD	Flare compression	CQHD06200106	1.00	2.55	
	1/2" OD	Flare compression	CQHD06200108	1.00	2.56	
	3/8" Taper	Male NPT	CQHD06200206	1.16	1.90	1.00
	3/4" Taper	Male NPT	CQHD06200212	1.16	2.26	1.00

CQV Coupling Bodies • PVDF

TERMINATION	TUBING/THREAD SIZE	TERMINATION TYPE	SHUTOFF	A	B	C
IN-LINE	1/4" OD	Flare compression	CQVD06100104	1.44	3.31	
	3/8" OD	Flare compression	CQVD06100106	1.44	3.38	
	1/2" OD	Flare compression	CQVD06100108	1.44	3.37	
	3/8" Taper	Male NPT	CQVD06100206	1.44	2.70	1.00
PANEL MOUNT	1/4" OD	Flare compression	CQVD06110104	1.82	3.24	
	3/8" OD	Flare compression	CQVD06110106	1.82	3.38	
	1/2" OD	Flare compression	CQVD06110108	1.82	3.37	
	3/8" Taper	Male NPT	CQVD06110206	1.82	2.70	1.00

CQV Coupling Inserts • PVDF

TERMINATION	TUBING/THREAD SIZE	TERMINATION TYPE	SHUTOFF	A	B	C
IN-LINE	1/4" OD	Flare compression	CQVD06200104	1.00	2.41	
	3/8" OD	Flare compression	CQVD06200106	1.00	2.57	
	1/2" OD	Flare compression	CQVD06200108	1.00	2.57	
	3/8" Taper	Male NPT	CQVD06200206	1.16	1.89	1.00

All measurements are in inches (millimeters) unless otherwise noted. Tubing must meet stated inside and outside diameters.

CQG SERIES CONNECTOR



The CQG06 Series high purity couplings feature our patented pressure-balanced, non-spill design. Molded virgin polypropylene and a 100% springless flow path provide broad chemical resistance and exceptionally high flow capacity, allowing instant disconnects (and reconnects), even under pressure.

Specifications ● ● ●

PRESSURE:

0 - 80 psig (0 - 5.5 bar)

TEMPERATURE:

32°F to 150°F (0°C to 66°C)

MATERIALS:

Main components:

Natural, virgin polypropylene

Seals: FKM (Simriz® FFKM optional)

Springs (non-wetted): Hastelloy® C

Flare nuts: PVDF

Lubricants: None used

Dual Containment Nut and Panel Mount Fitting:

Virgin, natural polypropylene

Flare nuts: PVDF

Panel nuts: HDPE

Panel mount o-rings: FKM

SPILLAGE/AIR INCLUSION:

<0.1 cc (ml)/disconnect (reconnect)

PANEL MOUNT: Optional adapter kit

TUBING SIZES:

3/8" to 3/4" flare; 3/8" to 3/4" NPT

WARNING: Pressure, temperature, chemicals, and operating environment can affect the performance of couplings. It is the customer's responsibility to test the suitability of CPC's products in their own application conditions.

FEATURES

Non-spill design

Pressure-balanced

Springless flow path design

BENEFITS

Ultimate protection from chemicals and fumes

Failsafe disconnect, even under pressure; easy to reconnect at high pressure

Eliminates source of metallic contaminants



These graphs are intended to give you a general idea of the performance capabilities of each product line. The shaded area of each graph represents the operating range of the product family, i.e., upper and lower values are shown. Therefore, depending on the exact coupling configurations selected, you can reasonably expect values to fall within the shaded area.

CQG06 Pressure Range

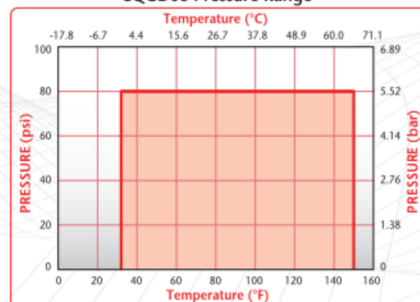

CQG06 Water Flow

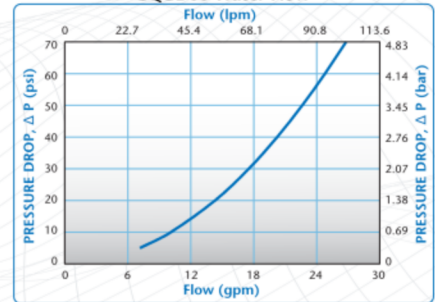

CQG SERIES CONNECTOR DIMENSIONS

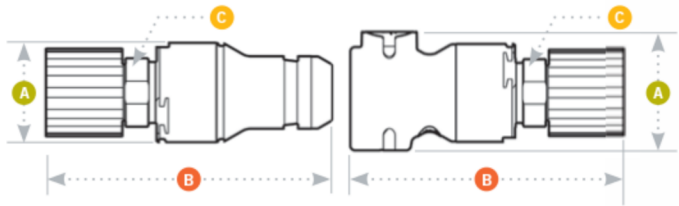

- A** = Height/Diameter
- B** = Total Length (including valve)
- C** = Hex Size on Main Component

	PANEL OPENING	PANEL THICKNESS MAX.-MIN.
COUPLING BODIES OR INSERTS	see drawing	.50 - .12

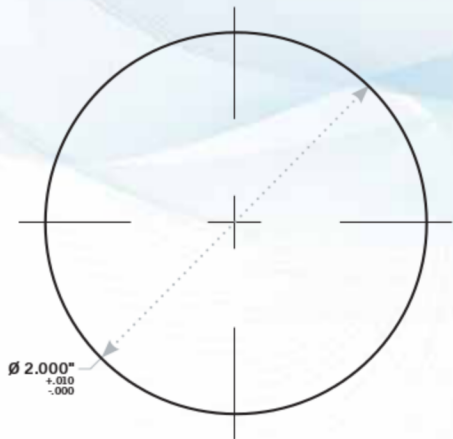

Coupling Bodies • POLYPROPYLENE

TERMINATION IN-LINE	TUBING/THREAD SIZE	TERMINATION TYPE	SHUTOFF	A	B	C
	3/8" OD	Flare compression	CQGD06100106	1.96	4.21	
	1/2" OD	Flare compression	CQGD06100108	1.96	4.42	
	3/4" OD	Flare compression	CQGD06100112	1.96	4.49	
	1/2" Taper	Male NPT	CQGD06100208	1.96	3.81	1.00

Coupling Inserts • POLYPROPYLENE

TERMINATION IN-LINE	TUBING/THREAD SIZE	TERMINATION TYPE	SHUTOFF	A	B	C
	3/8" OD	Flare compression	CQGD06200106	1.62	4.35	
	1/2" OD	Flare compression	CQGD06200108	1.62	4.45	
	3/4" OD	Flare compression	CQGD06200112	1.62	4.63	
	3/8" Taper	Male NPT	CQGD06200206±	1.62	3.81	1.00
	1/2" Taper	Male NPT	CQGD06200208	1.62	3.95	1.00
	3/4" Taper	Male NPT	CQGD06200212±	1.62	4.15	1.00

Panel Mount Adaptor • POLYETHYLENE

DESCRIPTION	PART NO.
Panel mount adapter kit (fits both bodies & inserts)	CQG06PMKIT01

All measurements are in inches (millimeters) unless otherwise noted. Tubing must meet stated inside and outside diameters.

ChemQuik® Dual Containment Flare Nuts • POLYPROPYLENE



The ChemQuik® Dual Containment System is an easy way to "double contain" critical chemical lines, protecting plant and personnel in case a primary process line ruptures or "sweats". The system provides a protective secondary line to catch any fluid and routes it to a safe location.

These fittings work with any ChemQuik coupling with fine thread flare terminations or a common flare style fitting. In addition, the panel mount version can be mounted into a pump cabinet or other panel mount connection point. The primary line can then be routed from the coupling directly to a pump, connected to a ChemQuik coupling at the panel mount fitting.

The "weep port" serves to vent the area between the primary and secondary lines so that pressure cannot build up in case of a primary line rupture. The leaking fluid can then be routed to a containment vessel or to a leak detector.

FLARE NUT	DESCRIPTION	FLARE FITTING	DESCRIPTION
CQDCNUT0408	Dual containment nut, 1/4" OD process line x 1/2" OD secondary containment line.	CQPMDCNUT0408	Panel mount dual containment nut, 1/4" OD Process line x 1/2" OD secondary containment line.
CQDCNU10612	Dual containment nut, 3/8" OD process line x 3/4" OD secondary containment line.	CQPMDCNU10612	Panel mount dual containment nut, 3/8" OD Process line x 3/4" OD secondary containment line.
CQDCNUT0812	Dual containment nut, 1/2" OD process line x 3/4" OD secondary containment line.	CQPMDCNUT0812	Panel mount dual containment nut, 1/2" OD Process line x 3/4" OD secondary containment line.
CQDCNU11216	Dual containment nut, 3/4" OD process line x 1" OD secondary containment line.	CQPMDCNU11216	Panel mount dual containment nut, 3/4" OD Process line x 1" OD secondary containment line.